

Graphic Instructions

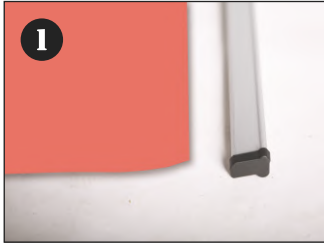

1. Put the graphic and top bar together like this



2. Remove the end caps



3. Open the top bar



4. Insert the graphic and press the top bar



5. Close the end caps of top bar

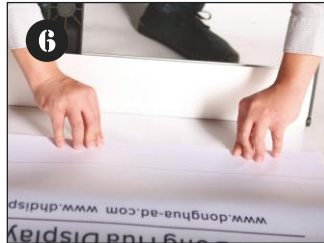

6. Put the graphic and base leader together like this



7. Remove the 3M glue and stick the graphic



8. Hold the graphic and remove the spring key



9. Allow the graphic go into the base

GRAPHIC SIZE :

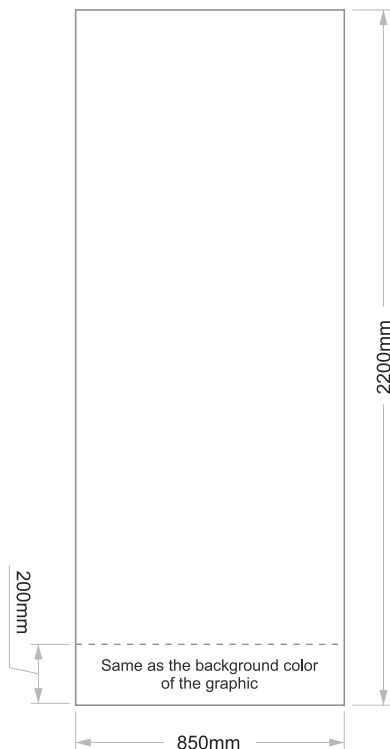

★ The tank is not available for beat and trample, especially the hammer and heels.



★ The safe height for filled with water tank is as shown picture, once it drops from a higher position, it will be broken.

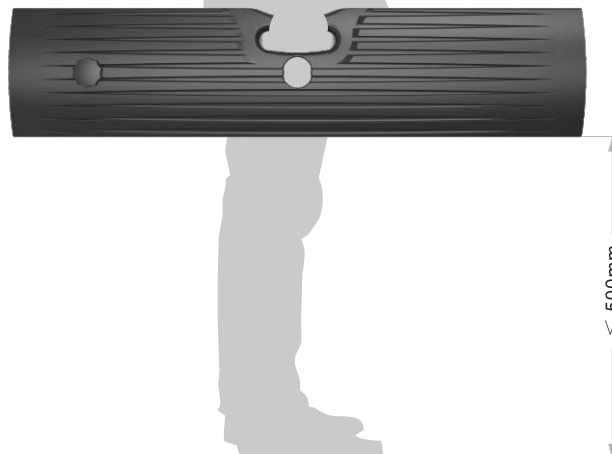

Structure Instructions



1. Bag with stand



2. Take out the stand from the bag



3. All prole on the ground



4. Add the water into the tank



5. Put the water tank on the base

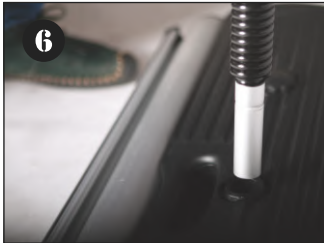

6. Insert the pole into the base



7. Adjust the pole with the height mark

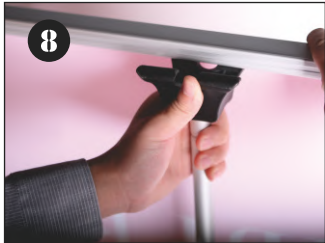

8. Pull out the graphic and x the top bar on the pole



9. Fix another graphic

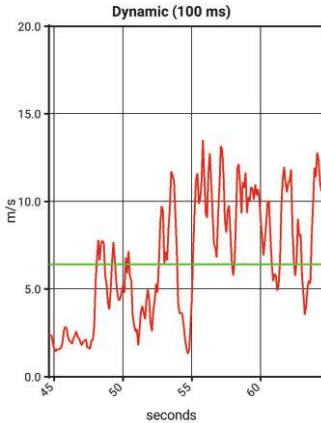
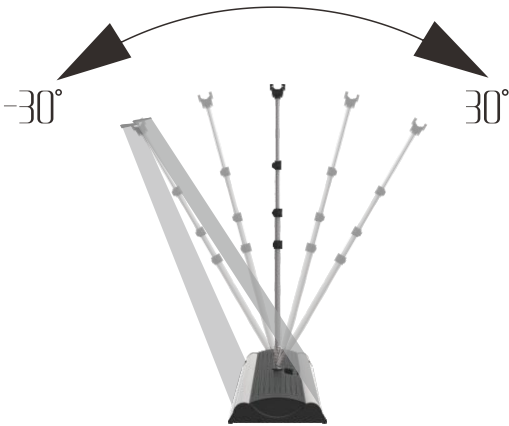

Test Result	Graphic Height	Wind Scale	Suitable Place
	2.0m	≤4	Doorway
	1.8m	≤5	Outdoor Open Space
	1.7m	≤6	Plaza, Kerbside
	1.6m	≤7	Lakeside